

**PLAN VIEW**

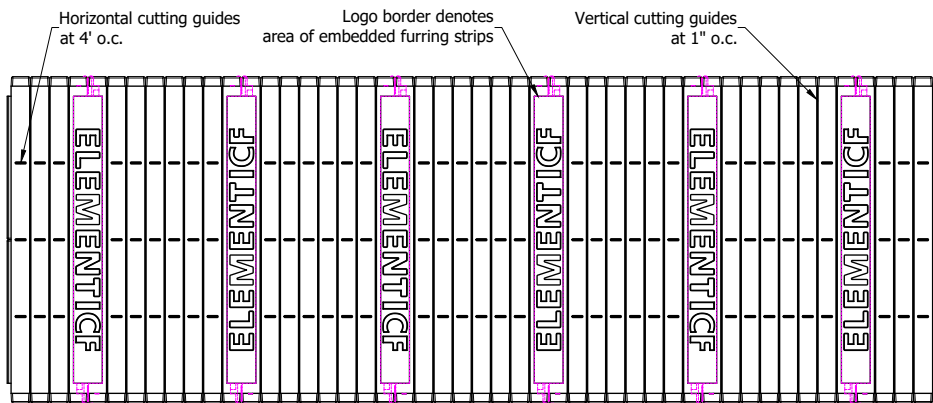

**SIDE ELEVATION**

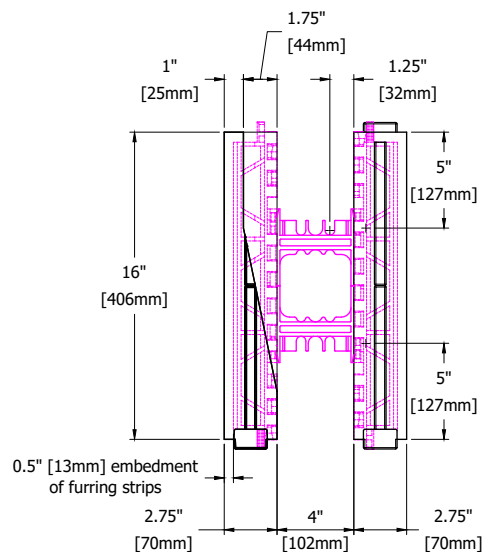

**END VIEW**

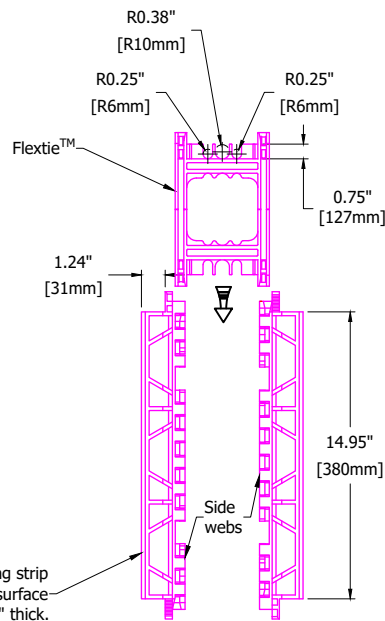
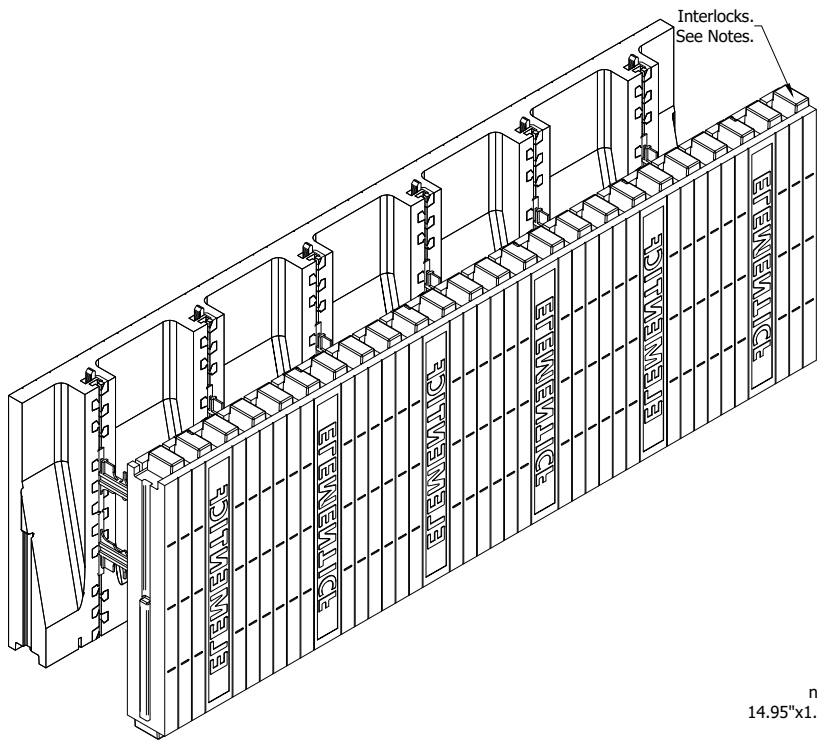

**WEB TIE COMPONENTS**

**TAPER TOP BLOCK SPECS**

Conc. Vol. (y3)	0.08
Conc. Vol. (ft3)	2.19
Conc. Vol. (m3)	0.062
Wall Area (sf)	5.333
R-value*	19.3
RSI*	3.39

\*EPS form panels only

**NOTES:**

1. Element Taper Top may be available with or without interlock along the top of the block. Confirm with your local Element ICF representative.

