

THE BUSINESS CASE FOR HIGH PERFORMANCE MID-RISE BUILDINGS



*The projects on this page were built with Logix ICFs by Logix Brands

© Copyright Logix Brands Ltd. (2023) All rights reserved.

No part of the work contained herein as covered by this copyright may be reproduced or used in any form, or any means – graphic, electronic or mechanical, including without limitation photocopying. By using these products, you agree to assume all risks associated therewith. See LogixBrands.com/Disclaimer-General for a full copy of disclaimer.

Important Disclaimer: Some of the images contained herein are of projects built using Logix ICF and are shown solely for illustrative purposes of an ICF system. These images are based on Logix ICF, and may not be relied upon in connection with a build using Element ICF. No guarantee, warranty, or representation whatsoever is made that Element ICF will be available as depicted, or, if available, will be of the same type, size, quality, location, or nature as depicted or illustrated in the images and videos contained herein.

WE BUILD LONG-TERM MONEY-MAKERS.



- **BUILD IN ANY WEATHER.**

Element forms are insulated, so they are unaffected by wet or cold conditions.

- **NO SHRINKAGE ISSUES.**

Unlike wood-frame, ICF construction has no differential shrinkage issues to detail around or accommodate.

- **DESIGN EASILY TO SEISMIC CONDITIONS.**

No gas code “progressive collapse” issues compared to masonry.

- **BUILD FAST AND EFFICIENTLY.**

A typical build rate can be “a floor every 10 days or so”, and with Element ICFs, a single crew can build the entire superstructure.

- **REDUCE OVERHEADS.**

Save up to 80% on the cost of construction insurance when compared to wood-frame.



FAST, COST-EFFECTIVE BUILDS

EFFICIENT COST-EFFECTIVE BUILDS



- **MORE RENTABLE SQUARE FOOTAGE.**
Efficient concrete construction minimizes non-rentable building areas.
- **LOWER REPAIR BILLS.**
Durable Element ICF walls resist damage and moisture - there's nothing to rot or mold.
- **DRAMATICALLY LOWER UTILITIES BILLS.**
These buildings are incredibly energy-efficient!
- **HIGHER LONG-TERM PROFITS.**
These significant ongoing cost savings will drop directly to your bottom line.

*The projects on this page were built with Logix ICFs by Logix Brands

WE MAXIMIZE YOUR BOTTOM LINE.



- **COMMAND HIGHER RENTS.**
Minimize tenant turnover.
- **UNITS SHOW WELL.**
Element ICF high performance buildings are quick to “rent up”.
- **ENHANCED PRIVACY.**
Sound-tight walls and floors provide more privacy.
- **BETTER ODOR CONTROL.**
Air-tight walls control odors.
- **IMPROVED TENANT SAFETY.**
Four hour fire-rated construction provides greater tenant safety and peace of mind.

MAXIMUM RESALE VALUE



MAXIMIZED REVENUE STREAM

- **HIGHER ANNUAL PROFITS.**
Lower operating costs puts more money back in your pocket.
- **ATTRACTIVE INVESTMENT POTENTIAL.**
The superior performance fundamentals built into Element ICF High Performance Mid-Rise Rental Buildings resonate strongly with long-term institutional investors.

*The projects on this page were built with Logix ICFs by Logix Brands



WE PUT SIX STEPS IN ONE PACKAGE.



MAXIMUM ENVELOPE PERFORMANCE

■ CONTINUOUS FOAM INSULATION

Two thick, continuous Element foam panels envelope the building to provide an effective wall assembly R-value of R25 or more.

■ AIR-TIGHT WALLS

The Element ICF wall assembly delivers up to 60% lower air infiltration than a traditionally-built wall. This enhances the thermal performance of the foam insulation and makes the building even more draft-free and comfortable.

■ 5-DAY THERMAL LAG

The Element ICF concrete core provides a 5-day thermal lag, further enhancing the thermal performance of the building. Living areas stay cooler in the summer months.

■ GREATER SAFETY AND PROTECTION

Element ICF walls are resistant to fire, earthquakes and damaging high winds, and also don't support mold or rot, thus lowering maintenance costs.

■ SOUND-TIGHT

The concrete core significantly reduces the penetration of outside noise.

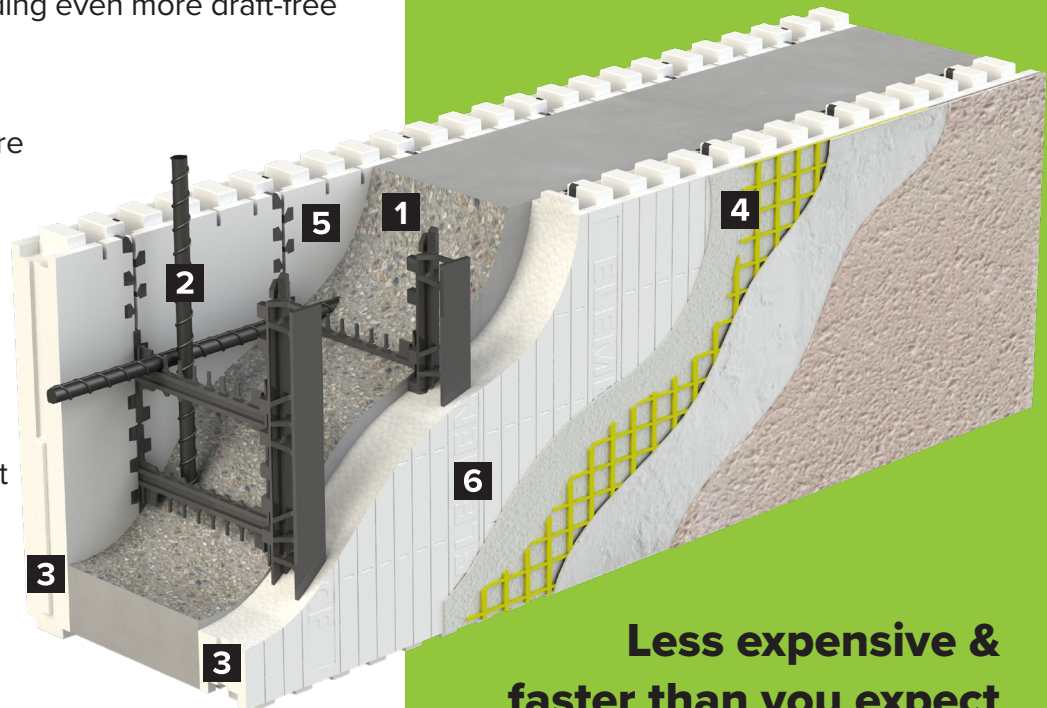

MAXIMUM CONSTRUCTION SPEED & EFFICIENCY

- 1 CONCRETE
- 2 STEEL REINFORCEMENT
- 3 INSULATION
- 4 AIR BARRIER
- 5 VAPOR BARRIER
- 6 FURRING STRIPS

Less expensive & faster than you expect high quality concrete construction to be!



CONTACT US NOW TO LEARN MORE.

LET'S GET STARTED!

As a first step, we recommend you:

- To better understand the underlying design principles, request the Element Typical Mid-Rise Details Booklet from ElementICF.com or
- **SEND US AN EMAIL OR CALL US AT 888.415.6449** to speak with a Element ICF Technical Advisor.

Logix Brands is The ICF Solutions Company.

We provide full-service support and solutions to shorten your learning curve and maximize project success.

- Design Assistance Services
- In-Class & On-Site Installer Training
- On-Site Technical Support
- Designer, Builder & Installer Referrals

WANT TO LEARN MORE?

Visit ElementICF.com or contact us at 888.415.6449. We can provide access to:

- project profiles;
- detailed product specifications and information;
- videos, reviews and testimonials; and
- much, much more.

*The projects on this page were built with Logix ICFs by Logix Brands



Element ICF is easy to learn and is accessible to framers, masons and concrete contractors.

ELEMENTICF®

info@elementicf.com
ElementICF.com

A PRODUCT BY
LOGIX®
BRANDS