

Keep it Simple.™

ENTERTAINMENT COMPLEXES

Theater owners and entertainment complex developers navigate within an exceptionally fast-changing industry and Element ICF is the ideal entertainment complex solution for today and tomorrow. It's a fast and inexpensive build with a great result – a tough and durable building that's as sound-proof, space-efficient and energy-efficient as they come.

HIGH PERFORMANCE ADVANTAGES

- Element ICF, with “6 steps in 1”, is simply faster and less expensive than you expect high quality concrete construction to be. And it's simpler too—with Element, a single crew can build the entire superstructure, largely unimpeded by cold winter conditions.
- Superior construction speed. Element ICF, with “6 construction steps in 1”, is typically faster than regular CMU construction. This means a shorter financing period and incoming revenues sooner than later.
- Sound-Proof. Sound transmission class ratings of 56 and higher for interior and exterior walls are easily achieved with typical Logix wall assemblies using an 8” concrete core. This is a much simpler than the common alternatives, such as double insulated 2 x 6 or 2 x 8 walls with 3”– 5” air gaps between walls.
- Using Element ICF to build the interior demising and shear walls creates a stronger structure and this in turn allows for a streamlined structural design and a lighter roof structure.
- Element ICF accommodates a wide variety of facades, which allows you to design the appearance of your building in alignment with your brand and image.

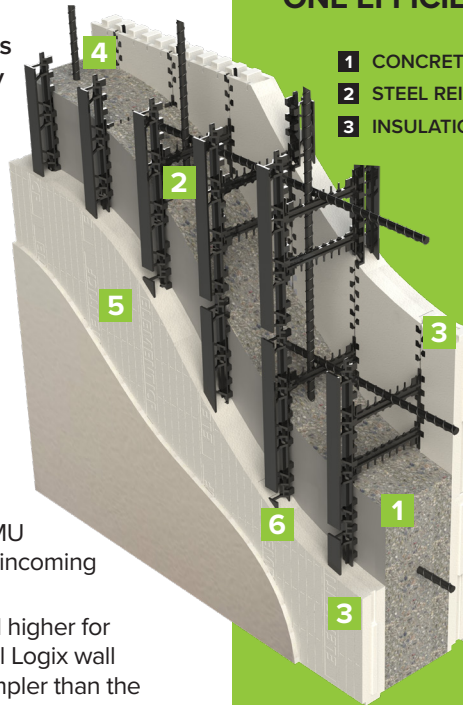

SIX CONSTRUCTION STEPS IN ONE EFFICIENT PACKAGE

- | | |
|-----------------------|------------------|
| 1 CONCRETE | 4 AIR BARRIER |
| 2 STEEL REINFORCEMENT | 5 VAPOR BARRIER |
| 3 INSULATION | 6 FURRING STRIPS |

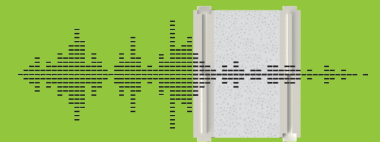

EXCEPTIONAL SOUND-PROOFING

Your occupants will notice and appreciate the additional sound control and privacy that an Element ICF building provides.

Element XRV™ Delivers More R-Value And Additional Energy Savings.



Complete The Efficient ICF Envelope By Framing All Openings With Element Pro Buck™

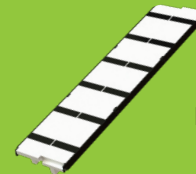

LOGIX BRANDS IS THE ICF SOLUTIONS COMPANY

Logix Brands provides full-service support and turn-key expertise to designers, GC's and installers to shorten the learning curve and maximize project success.

- Design Assistance
- Crew-Specific Training & On-site QC
- ICF Advisory Services

Important Disclaimer: Some of the images contained herein are of projects built using Logix ICF and are shown solely for illustrative purposes of an ICF system. These images are based on Logix ICF, and may not be relied upon in connection with a build using Element ICF. No guarantee, warranty, or representation whatsoever is made that Element ICF will be available as depicted, or, if available, will be of the same type, size, quality, location, or nature as depicted or illustrated in the images and videos contained herein.

© Copyright Logix Brands Ltd. (2024) All rights reserved. No part of the work contained herein as covered by this copyright may be reproduced or used in any form, or any means – graphic, electronic or mechanical, including without limitation photocopying. By using these products, you agree to assume all risks associated therewith. See LogixBrands.com/Disclaimer-General for a full copy of disclaimer.

CONTACT US for more information or to arrange a meeting with a Element ICF Technical Advisor.

info@elementicf.com 888.415-6449

ElementICF.com

