

PLAN VIEW
Outside Corner Application

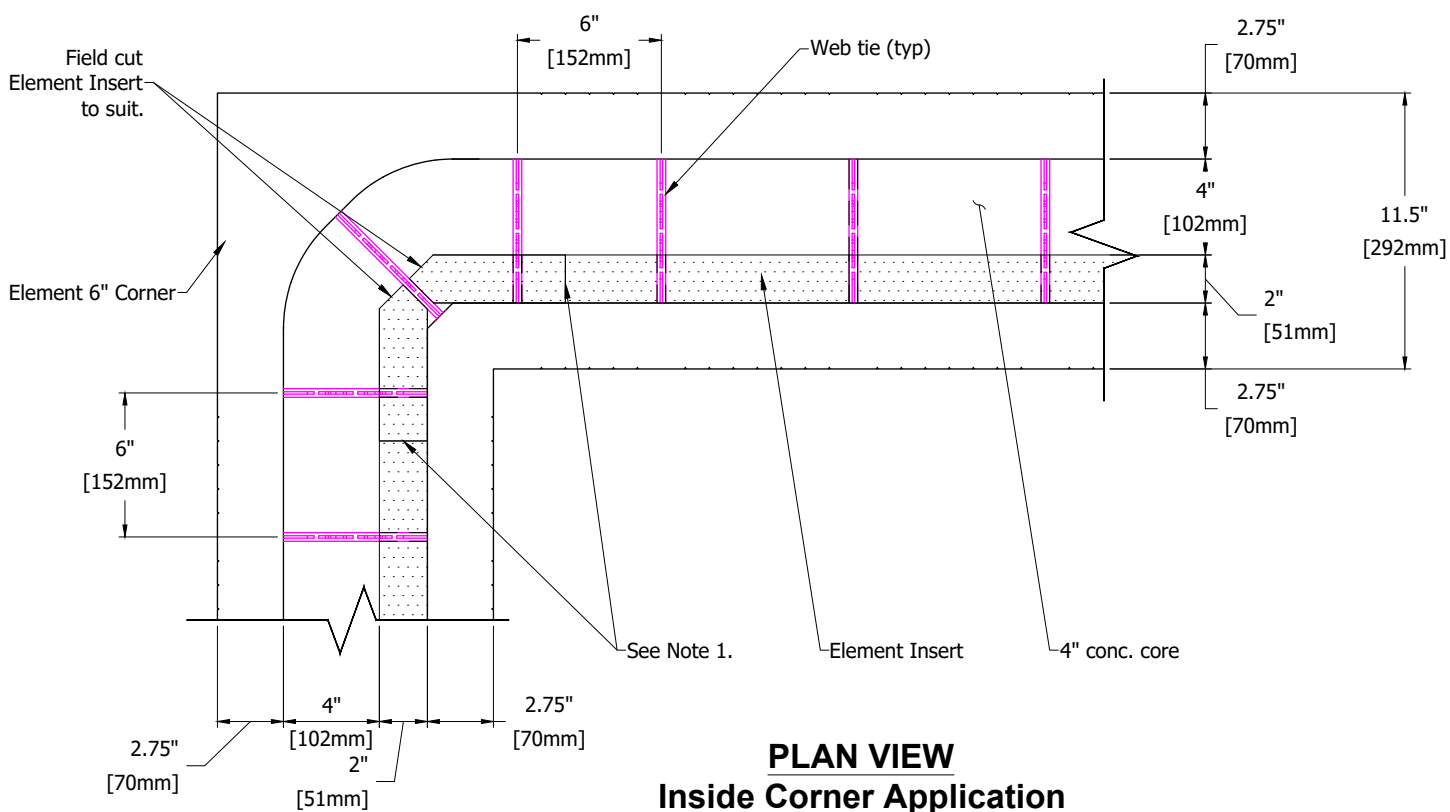

PLAN VIEW
Inside Corner Application

NOTES:

1. Where spacing between web ties is not 8" o.c. field cut Element Insert to accommodate web tie spacing.
2. Element Inserts can be installed in either Site-assembled or Preformed Element ICF blocks.

ElementICF.com A Product By Logix Brands Ltd. 1-866-944-0153

©Copyright Logix Brands Ltd. (Year of Publishing) All rights reserved. No part of the work contained herein as covered by this copyright may be reproduced or used in any form, or any means - graphic, electronic or mechanical, including without limitation photocopying.

By using these drawings, you agree to assume all risks associated therewith. See Logixbrands.com/Disclaimer-Drawings for a full copy of disclaimer.

| | | |
|--|---------------------------|-------------------|
| Drawing: 5.1.3.2.1 | Date: Dec 29/25 | Pg: 1/1 |
| Title: ELEMENT INSERT WITH ELEMENT 6" CORNER | | |