

NOTES:

1. Element ICF wall reinforcement not shown for clarity.
2. Site-built pilasters can be further secured using combinations of various Flextie sizes with Xtender clips. Alternatively, builder may choose to leave out Flexties and Xtender clips if there will be heavy congestion of rebar within the pilaster.
3. Check availability of Element Buck Brace with your local Logix Brands representative.



ElementICF.com A Product By Logix Brands Ltd. 1-866-944-0153

©Copyright Logix Brands Ltd. (Year of Publishing) All rights reserved. No part of the work contained herein as covered by this copyright may be reproduced or used in any form, or any means - graphic, electronic or mechanical, including without limitation photocopying.

By using these drawings, you agree to assume all risks associated therewith. See Logixbrands.com/Disclaimer-Drawings for a full copy of disclaimer.

Drawing:
5.21.2

Date:
Jun 16/25

Pg:
1/3

Title:
**VARIOUS SITE-BUILT PILASTER FORM
SUPPORT EXAMPLES - PLAN VIEW**

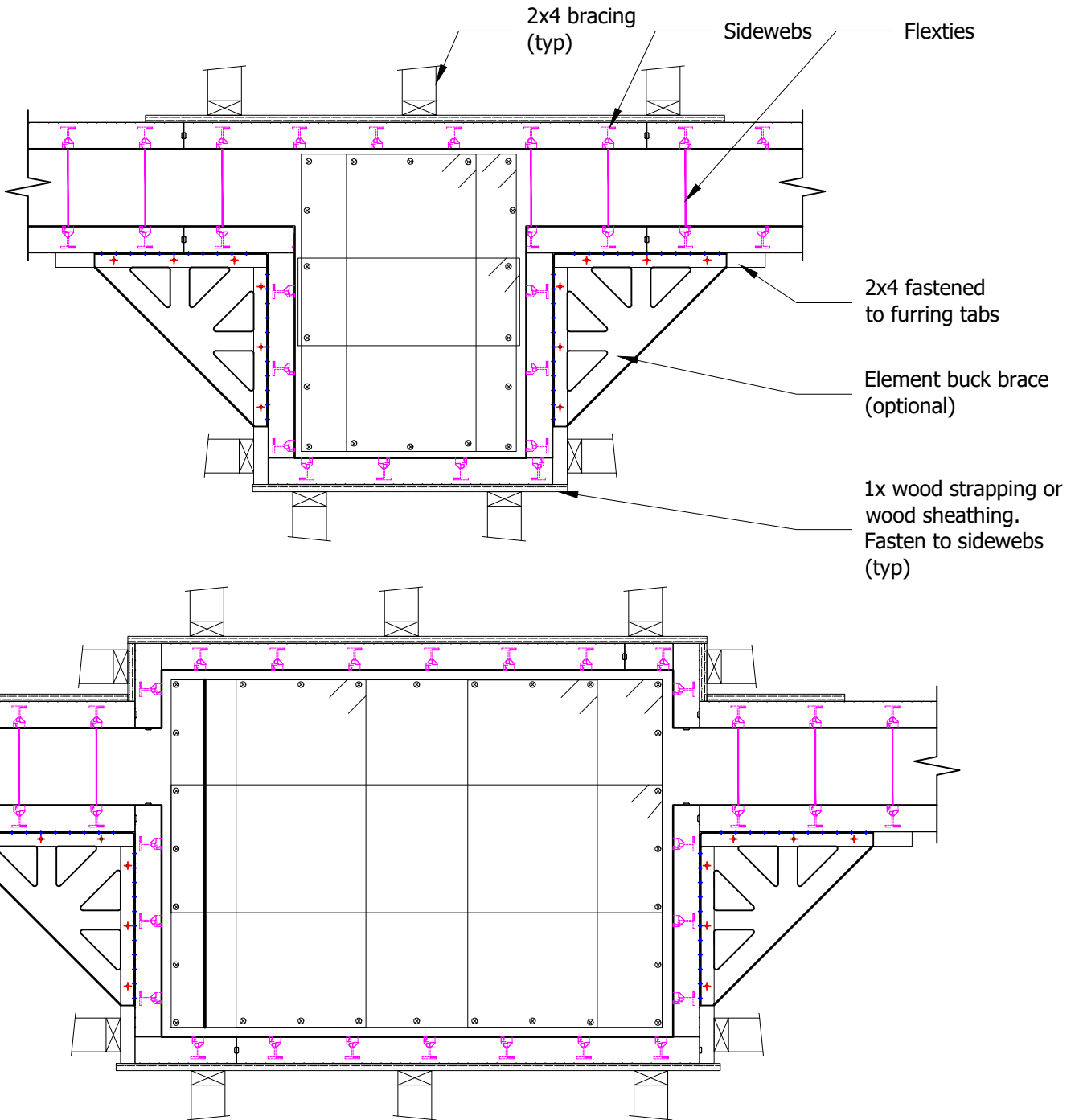

NOTES:

1. Element ICF wall reinforcement not shown for clarity.
2. Site-built pilasters can be further secured using combinations of various Flextie sizes with Xtender clips. Alternatively, builder may choose to leave out Flexties and Xtender clips if there will be heavy congestion of rebar within the pilaster.
3. Check availability of Element Buck Brace with your local Logix Brands representative.



ElementICF.com A Product By Logix Brands Ltd. 1-866-944-0153

©Copyright Logix Brands Ltd. (Year of Publishing) All rights reserved. No part of the work contained herein as covered by this copyright may be reproduced or used in any form, or any means - graphic, electronic or mechanical, including without limitation photocopying.

By using these drawings, you agree to assume all risks associated therewith. See Logixbrands.com/Disclaimer-Drawings for a full copy of disclaimer.

Drawing:
5.21.2

Date:
Jun 16/25

Pg:
2/3

Title:
VARIOUS SITE-BUILT PILASTER FORM SUPPORT EXAMPLES - PLAN VIEW

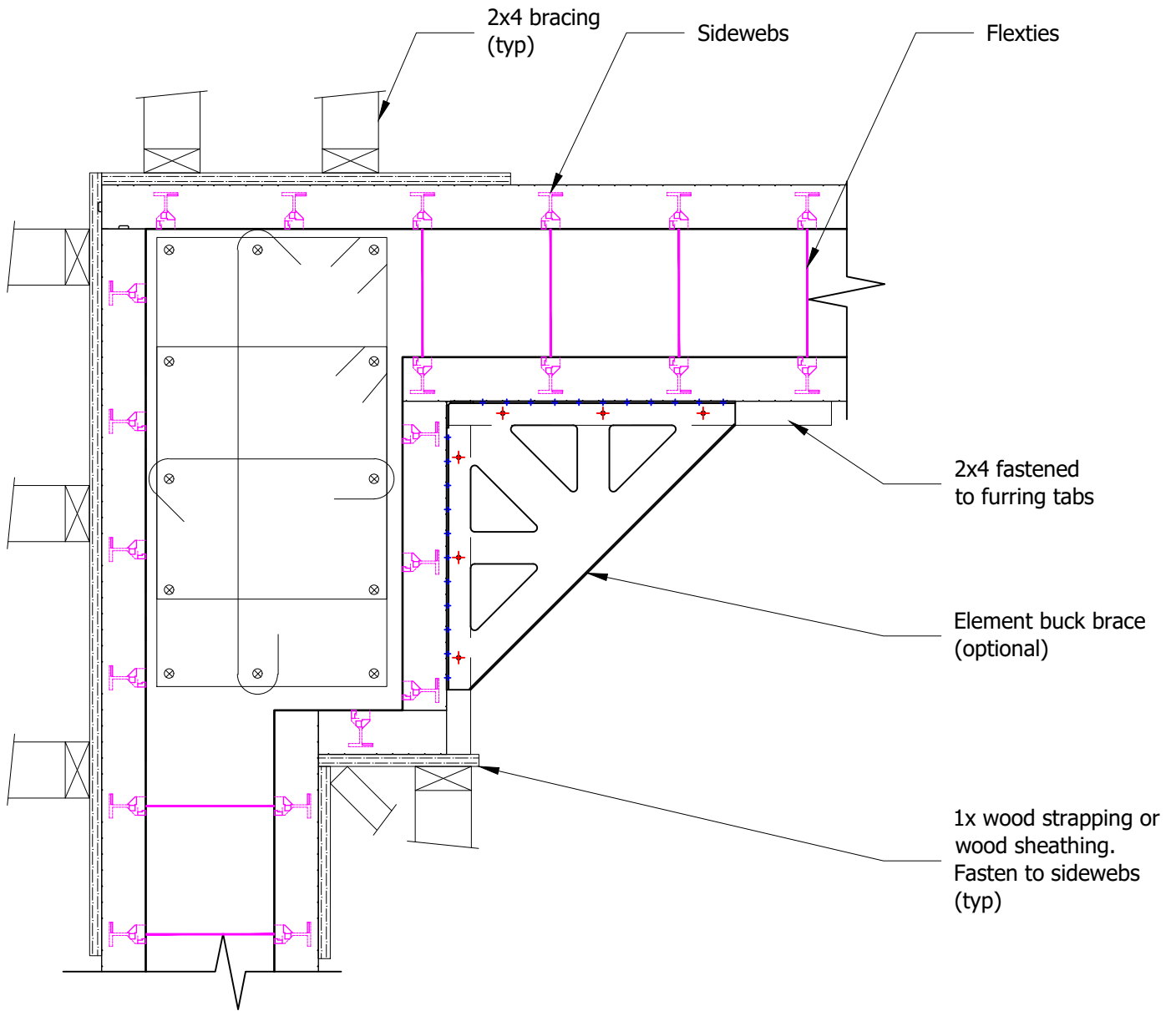

NOTES:

1. Element ICF wall reinforcement not shown for clarity.
2. Site-built pilasters can be further secured using combinations of various Flextie sizes with Xtender clips. Alternatively, builder may choose to leave out Flexties and Xtender clips if there will be heavy congestion of rebar within the pilaster.
3. Check availability of Element Buck Brace with your local Logix Brands representative.



©Copyright Logix Brands Ltd. (Year of Publishing) All rights reserved. No part of the work contained herein as covered by this copyright may be reproduced or used in any form, or any means - graphic, electronic or mechanical, including without limitation photocopying.

By using these drawings, you agree to assume all risks associated therewith. See Logixbrands.com/Disclaimer-Drawings for a full copy of disclaimer.

Drawing:
5.21.2

Date:
Jun 16/25

Pg:
3/3

Title:
VARIOUS SITE-BUILT PILASTER FORM SUPPORT EXAMPLES - PLAN VIEW