

HORIZONTAL CORNER REINFORCEMENT. SEE DETAIL A

HORIZONTAL ICF WALL REINF. STACKED SPLICE (SHOWN SHADED FOR CLARITY)

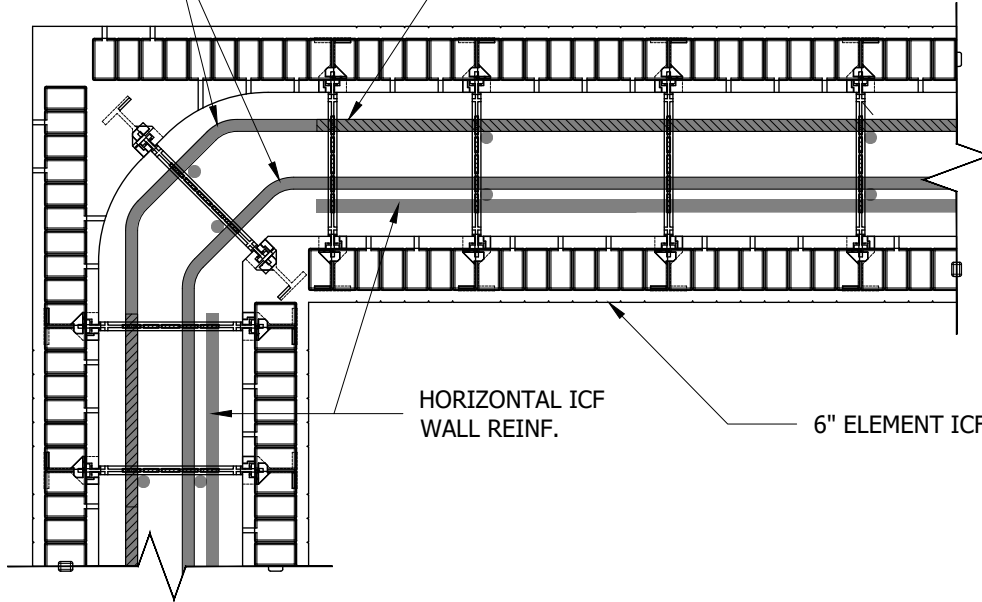

ELEMENT 6" CORNER

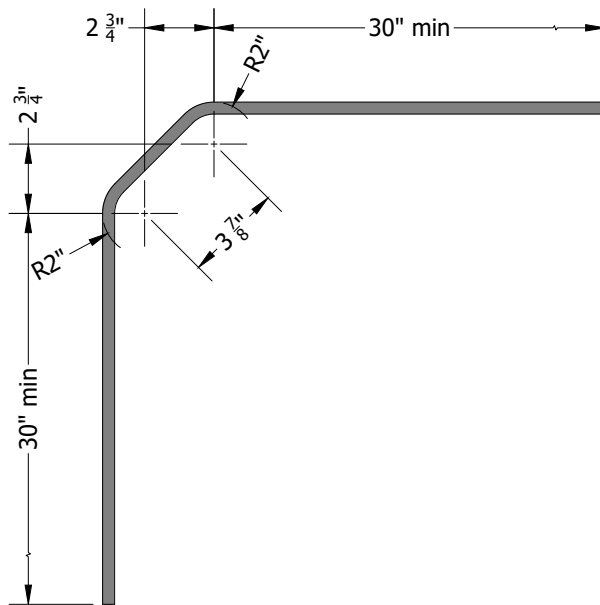

**DETAIL A
CORNER REINFORCEMENT DETAIL
(NTS)**

NOTES:

1. To minimize congestion rebar is permitted to be stacked splice, where needed.
2. Details shown are typical corner double mat reinforcement examples. Alternate details are permitted and may be dictated by design and code requirements.
3. Rebar shown are #4 (10M).
4. Lap length between horizontal corner bar and horizontal ICF wall reinforcement is 24" minimum for #4 (10M) bars or smaller.
5. Noncontact lap splices permitted. Shall not exceed the smaller of $\frac{1}{3}$ lap splice and 6".



©Copyright Logix Brands Ltd. (2024) All rights reserved. No part of the work contained herein as covered by this copyright may be reproduced or used in any form, or any means - graphic, electronic or mechanical, including without limitation photocopying.

By using these drawings, you agree to assume all risks associated therewith. See Logixbrands.com/Disclaimer-Drawings for a full copy of disclaimer.

Drawing:
5.14.2.4

Date:
Dec 10/24

Pg:
1/1

Title:
**DOUBLE MAT REINFORCEMENT AT
ELEMENT 6in CORNER**